

The values and data on this site are for the 2017 Revaluation Grand List. Assessments are computed at 70% of the estimated market value of real property as of October 1, 2017. If you wish to review your property information and value, please call Tyler Technologies at (860) 675-2348 to make an appointment for an Informal Hearing. Please do not call the Assessor's Office.



Information on the Property Records for the Municipality of Farmington was last updated on 1/1/2018.

### Parcel Information

Location:	255 MT SPRING RD	Property Use:	Residential	Primary Use:	Residential
Unique ID:	13050255	Map Block Lot:	0041 1D	Acres:	4.28
490 Acres:	0.00	Zone:	R80	Volume / Page:	0134/0199
Developers Map / Lot:		Census:	4602-02		

### Value Information

	Appraised Value	Assessed Value
Land	302,890	212,020
Buildings	263,808	184,670
Detached Outbuildings	0	0
Total	566,698	396,690

# Owner's Information

## Owner's Data

FASOLO MARY L  
 JOHN J FASOLO  
 18 MOSES MEADE ROAD  
 CANAAN, CT 06018

## Building 1

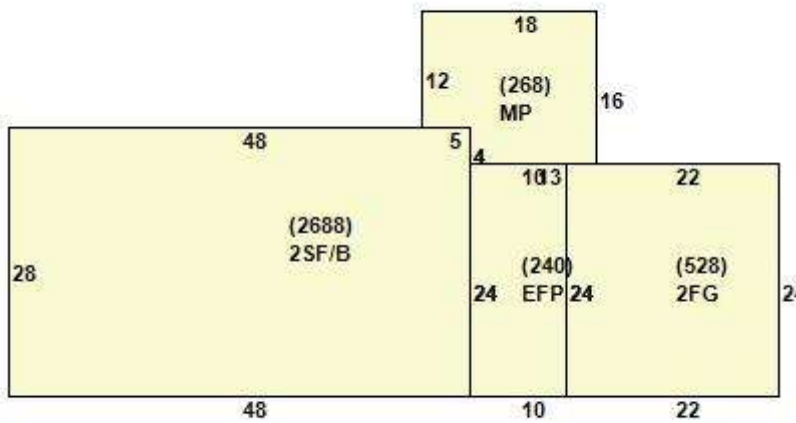

Building Use:	Single Family	Style:	Colonial	Living Area:	2,688
Stories:	2.00	Construction:	Wood Frame	Year Built:	1966
Total Rooms:	8	Bedrooms:	4	Full Baths:	3

Half Baths:	0	Fireplaces:	3	Heating:	Hot Water
Fuel:	Oil	Cooling Percent:	0	Basement Area:	1,344
Basement Finished Area:	672	Basement Garages:	0	Roof Material:	Asphalt
Siding:	Wood Shingles	Units:			

### Special Features

Fireplace Masonry Chimney	2
---------------------------	---

### Attached Components

Type:	Year Built:	Area:
Frame Garage	1966	528
Masonry Patio	1966	268
Enclosed Porch	1966	240

Information Published With Permission From The Assessor